

**SECURITY
OR SAFETY**
controllers & more

Touch-Type Graphic Recorder

GR200
Graphic Recorder

High durability

Stylish design

High reliability and performance

3 different languages available

Remote monitoring by smart phone



Distribuidor
Master **HANYOUNG nux**

GR200 Touch-Type Graphic Recorder

Features

- **High-definition screen**
5.7" 640×480 TFT-LCD
- **Multi input type**
2 kinds of RTD, 12 kinds of thermocouple, 4 kinds of DC voltage
- **Trend view function**
Users can input special event messages on the graphs
- **Supply big capacity memory**
SD and SDHC memory card available
- **422/485 communication function (Modbus, PC Link)**
Supply communication program for free
- **3 different languages**
Korean, English, Chinese
- **Ability to save data and back up parameter through SD Card**
- **Remote monitoring by smart phone**



Remote monitoring by smart phone

- When connecting to ethernet converter, HMCE-103, remote monitoring service with Smartphone Apps is available
- When alarm rings at GR200, you can know it in real time through Smartphone's alarm facility (In-Study)

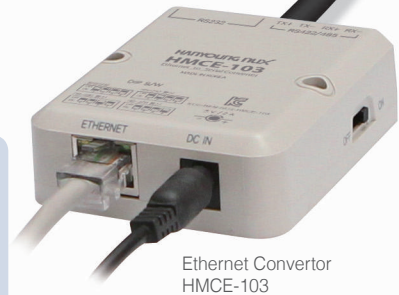

Ethernet Converter
HMCE-103

Various display screens



Text view



Trend view



Bar graph view

Application



Temperature & humidity chamber

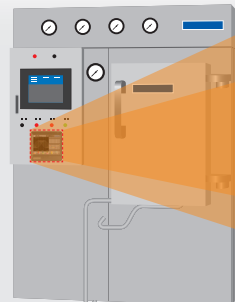

Food sterilizer

GRAPHIC RECORDER USING THE TOUCH PANEL



Menu screen icon



Selection of trend view, text view, bar graph view

Operating screen



Channel configuration

Set up arithmetic function for input parameter



Check the save log

Checking the saved graph or copying the internal memory of data to SD Card



Warning and DI

Set up alarm or contact input (D.I) parameter



Function configuration

Set up the operation parameter



History management

Display & save the event record and display the output status in real time



Date / reservation configuration

Set up a present time or start / close time for reservation



System configuration

Set up language in use, password and communication etc

History report

Save event or error history.
Present output status can be checked in the screen



Graphic viewer

User can check data in the internal memory or SD card.
Saved data can be zoom in or zoom out based on time axis or size axis

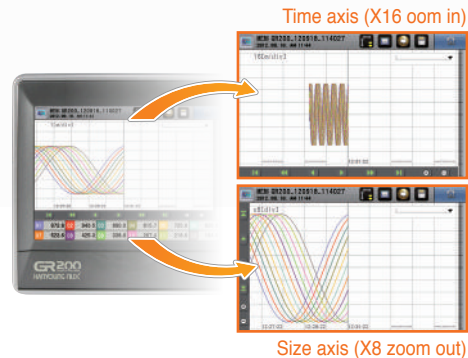

Trend view function

Display special event messages on the graphs



Arithmetic function

Various arithmetic functions

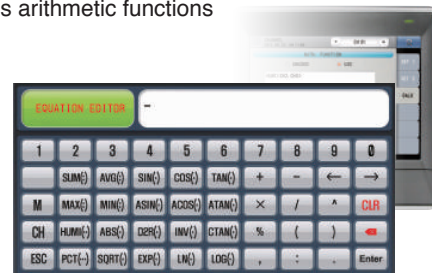

Consumer Logo

Possible to change the display of logo what consumers want



Suffix code

Model	Code	Description
GR200 -	□ □ □	GR200 Graphic recorder
Input channel	2	2 channels
	4	4 channels
	8	8 channels
	12	12 channels
Input / Output (DI / DO)	N	None
	1	D.I 2 + Relay 6
	2	D.I 4 + Relay 12
Communication	0	RS 422/485
	1	ETHERNET (On development)

Dimension & panel cutout

Dimension (Unit : mm)

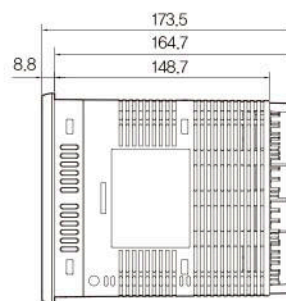
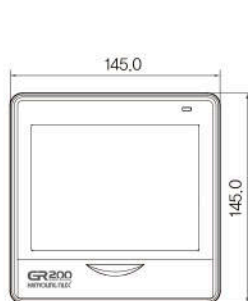

Panel cutout (Unit : mm)

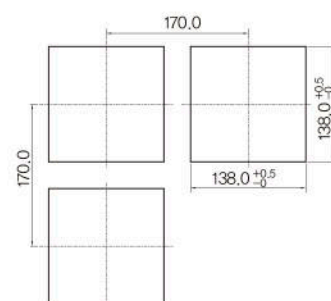

Specification

General specification	Power supply voltage	100 - 240 V AC (voltage fluctuation : $\pm 10\%$)
	Power frequency	50 - 60 Hz
	Power consumption	max 22 VA
	Dimension (mm)	144 (W) \times 144 (H) \times 173.5 (D)
	Weight	Approx. 1.3 kg
Input	Channel	2 Channels, 4 channels, 8 Channels, 12 Channels
	Input type	RTD 2 type (Pt-100, KPt-100), Thermocouple 12 type (K, J, E, T, R, B, S, L, N, U, Wre 5-26, PL-II) DC voltage 4 type (-10 - 20 mV, 0 - 100 mV, 1 - 5V, 0 - 30 V)
	Sampling time	250 ms
	RTD measuring current	Approx 0.21 mA
	Accuracy	$\pm 0.15\%$ of F.S, ± 1 digit (Except RJC temperature error)
	RJC temperature error	$\pm 2.0^\circ\text{C}$ (0 ~ 50 $^\circ\text{C}$)
	Burn-out	Display UP-Scale
	Alarm	2 settings within each channel
Alarm	Alarm setting	2 settings within each channel
	Alarm type	High/Low, Alarm within high/low range, Alarm without high/low range etc..
Save function	Internal memory	Non-volatile flash memory (80 MB) : In case of 1 second of record cycle, It saves data for 15 days
	External memory	SD card (2GB) : In case of 1 second of record cycle, it saves data for 1 year. (Support SDHC)
	File type	FAT 16/32 (SD card)
	Record cycle	1, 2, 5, 10, 20, 30, 60, 120 sec
Display	LIST	Display important event messages in the trend view
	Indicator	TFT color LCD (115.2 mm \times 86.4 mm, 640 \times 480 pixel) LED Backlight
	Language	Korean, English, Chinese
	Screen setting	Trend view, Text view
	Save history view	Check saved data and Provide zoom in & zoom out function
D.I. (Option)	External direct input (DI)	2 contacts, 4 contacts
	Input type	Non-voltage contact input
Output (Option)	Contact output	6 contacts, 12 contacts (N.O)
	Contact capacity	3 A 250 V AC (3 A 30 V DC)

Terminal wiring diagram

